



Plasma 56 Compressor Inverter



This industry leading plasma cutter requires NO external air supply due to the integration of a medical grade, maintenance free, ceramic Compressor.

This solution offers complete **INDEPENDENT OPERATION** and portability.

This exceptionally energy efficient power source boasts an incredible 20mm CLEAN CUT capacity with a severance cut of 25mm.

The machine requires a standard 400V supply but only needs a 16amp fuse for full operation.

The PLASMA 56 Compressor is also fully generator compatible only requiring 8KVA making it the perfect solution for any **SITE or workshop applications.**

Main Features:

- Torch safety circuit
- Cut capacity
 - Recommended 13mm
 - Maximum 20mm
 - Severance 25mm
- Quick disconnect 4 metre hand torch
- Extended Consumables Available
- PFC (Power Factor Correction) inverter power source
- Medical grade, maintenance free built in compressor
- 2 year parts and labour warranty

Specifications

Input Voltage	400V 50-60HZ
Fuse rating	16 amp
Engine driven generator requirements	8KVA
Cutting current	10-50A
Duty cycle EN60974-1	35% 50A - 60% 35A - 100% 25A
Protection class	IP23
Approvals	EN60974/1/7/10
Dimensions	270 x 440 x 570H mm
Weight	25kg

Torch Spares

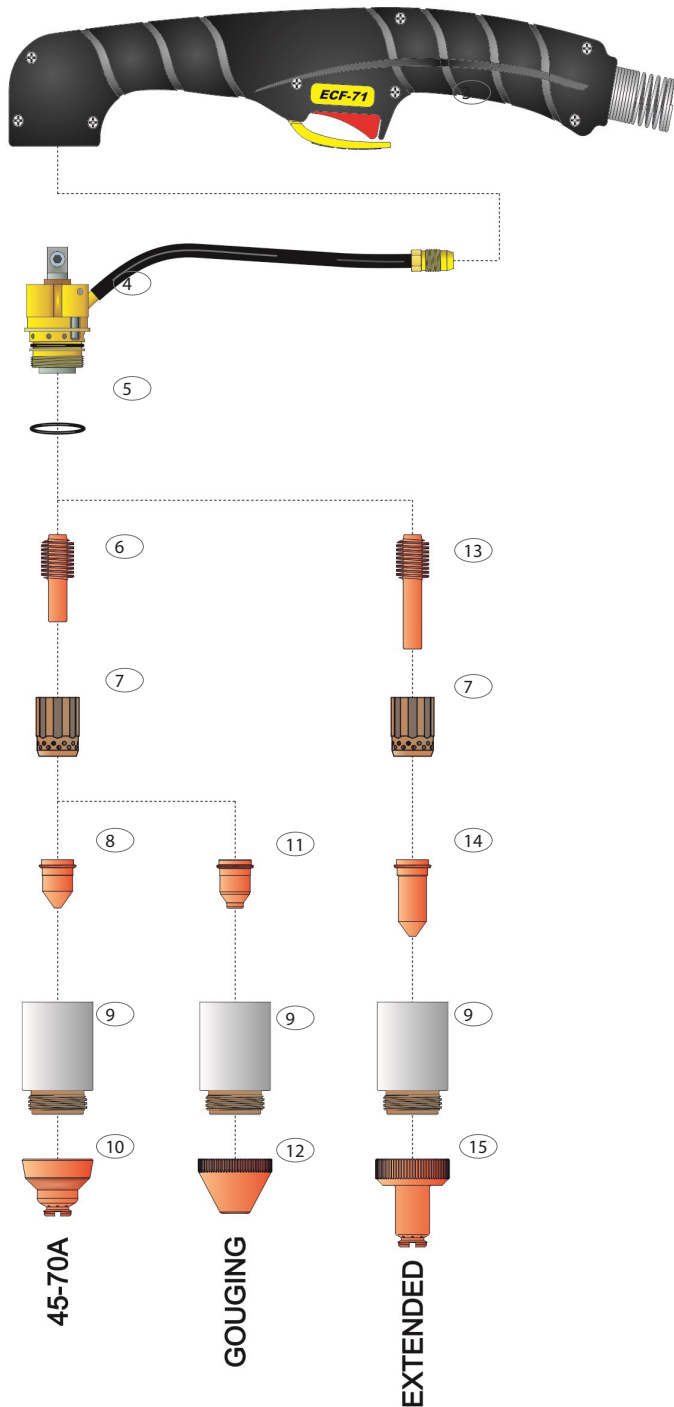

Item	Part No.	Description	Qty
1	CAP00471	Plasma 56 Compressor Inverter	1
2	WC535473	EFC70 Hand torch (Direct Fitting)	1
3	WC356656.B	Torch Handle Kit	1
4	WC356654.B	EFC70 Torch Head	1
5	WC356655.B	Torch Head O Ring	10
6	WC356555.B	Electrode	10
7	WC356556.B	Swirl Ring	2
8	WC356557.B	45Amp Cutting Tip	10
	WC356560.B	70Amp Cutting Tip	
9	WC356657.B	Nozzle Holder	1
10	WC356559.B	Shield Cap For Contact Cutting	2
11	WC356596.B	45Amp Cutting Tip For Gouging	10
	WC356597.B	70Amp Cutting Tip For Gouging	
12	WC356598.B	Shield Cap For Gouging	2
13	WC356561.B	Extended Electrode	10
14	WC356562.B	Extended 45Amp Cutting Tip	10
	WC356597.B	Extended 70Amp Cutting Tip	
15	WC356564.B	Extended Shield Cap	2
16	WC540130B	Starter Kit	

Optional Starter Kit

